

## 562/564 Series Circuit Board Mount Blocks for TE5/TR5 Type Fuses



Product Characteristics		
	562 Series	564 Series
Compatible Fuses	TR5/TE5	
Materials	<b>Block:</b> Black Thermoplastic, UL94 V-0 PET <b>Terminals:</b> Copper alloy; solderable tinned	
Electrical Data (23°C)	<b>Rated Voltage:</b> 250V <b>Max. Current/Power:</b> 6.3A/1.6W	
Mounting	PC Board, 5.08mm pin spacing	PC Board, 5.08mm pad spacing
Minimum Cross Section	Conducting path - 0.1mm <sup>2</sup>	Conducting path - 0.1mm <sup>2</sup>
Unit Weight	0.12g	0.44g

### Agency Approvals

Agency	Agency File Number	
	562 Series	564 Series
	E14721	E14721

### Ordering Information

Ordering Number	Circuit Board Mounting	Packaging
<b>56200001009</b>	Thru-Hole	1000 (Bulk pack)
<b>56400001009</b>	Surface Mount	1500 (Tape /Reel)

### Dimensions units in mm

#### 562 Series Holder

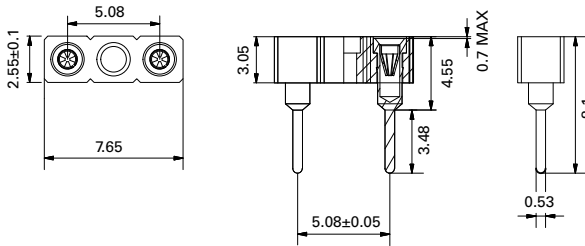

#### 564 Series Holder

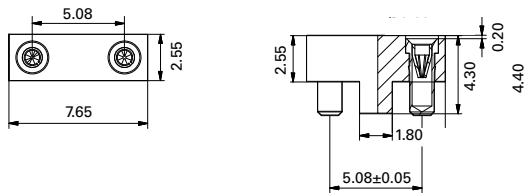

### Additional Information



**Datasheet 562 Series**



**Resources 562 Series**



**Samples 562 Series**



**Datasheet 564 Series**



**Resources 564 Series**



**Samples 564 Series**

**Disclaimer Notice** - Information furnished is believed to be accurate and reliable. However, users should independently evaluate the suitability of and test each product selected for their own applications. Littelfuse products are not designed for, and may not be used in, all applications. Read complete Disclaimer Notice at: [www.littelfuse.com/disclaimer-electronics](http://www.littelfuse.com/disclaimer-electronics).